

Wich Type of Rock Buckets do ERVA Produce?

Standart Rock Bucket:

This buckets are used to excavate loose or disaggregated abrasiv materials and to dig low consistency abrasives. ERVA uses AR400 (AR500) class steel at the cutting edge, AR400 class steel at the side bars and St52-3 steel on the body and speciall abrasiv resistant steels at the wears. The sheet thickness are increased. ERVA strengthens also this buckets inside, at the hooks, tork sheet, back and side sheets with extra supports.

Blok Buckets:

Made entirely in high performance abrasionresistant steel (Hardox 400), it is clearly suited to moving and loading masses, boulders, blocks of marble, etc., of significant size. Its unusual elongated shape and toughness ensure maximum support and deep penetration on any type of ground. Available with or without replaceable teeth.

RipperBuckets:

With its special shape, the ripper bucket is ideal for working on very hard terrain. The staggered alignment of the teeth concentrates the force initially on the central tooth and then on the two lateral ones, increasing penetration even in extreme conditions.

MultiBuckets:

This buckets are used to ripp and remove blocks and soil.

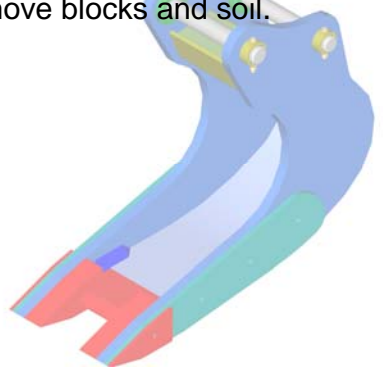
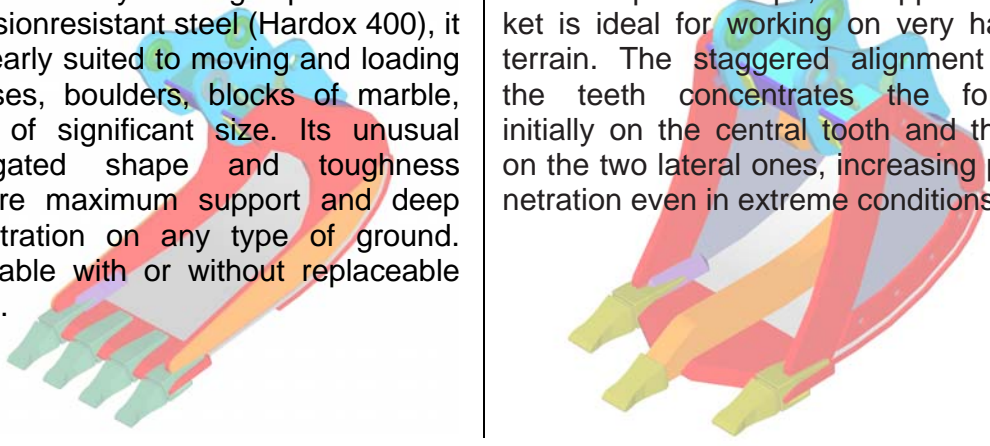

2007.03.07

2007-03-07

2007.05.01

2007.05.01